

# SmartMaster

Art. No.: 64 302 01



## Technical Data

Filter	
Filter stages	3
Filter method	Storage Filter
Filter surface	140 ft <sup>2</sup>
Type of filter	Filter cassette
Filter material	Non-woven fibre
Filter efficiency	> 99,5 %
Filter class	E12
Additional filters	Two pre-filters
Basic data	
Extraction capacity	559 cfm
Max. fan performance	1295 cfm
Maximum vacuum	6 inch WC
Weight	159 lbs
Motor power	1.48 hp
Power supply	1 x 115 V / 60 Hz
Rated current	13.9 A
Control voltage	115 V
Noise level	72 dB(A)
Additional information	
IFA-Certification	W3-Approved
Fan type	Radial fan
Quantity of extraction arms	1
Exhaust arm type	flexible exhaust arm
Diameter extraction arm	
Length of exhaust arm	

## Applications

- Suitable for all materials, including high-alloy steel
- Low amounts of smoke/dust
- Occasional use

## Benefits

- Exhaust arm requires less adjustment due to flow-optimised exhaust hood design
- Increased safety due to filter monitoring
- Flexible use due to hose connection

## Properties

- W3/IFA certified
- Exhaust arm 2 m
- Handle with cable holder
- Rotating exhaust hood



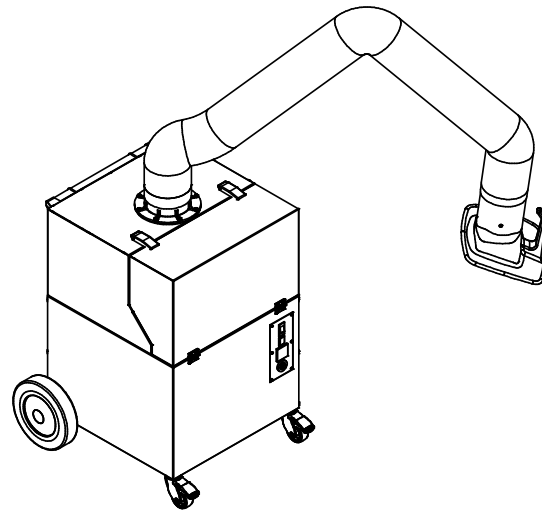
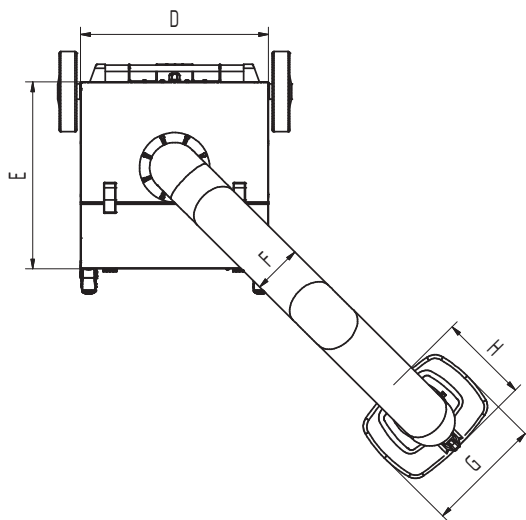
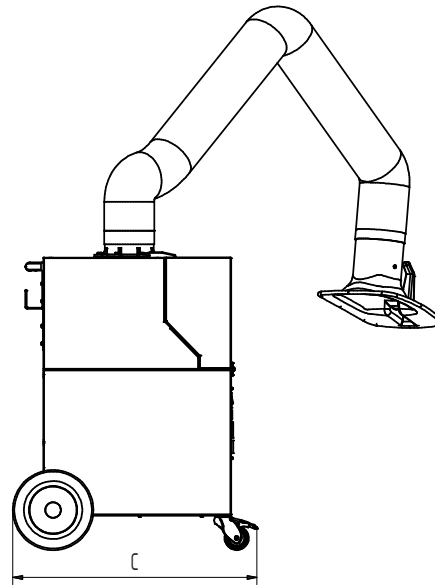
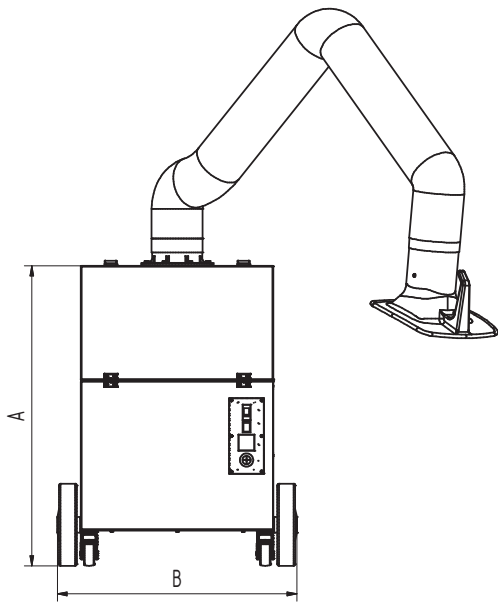

## Technical Data

### Dimensions

A	35.8 in
B	28.4 in
C	29.6 in
D	22.8 in
E	22.8 in
F	5.9 in
G	14.2 in
H	11.6 in